

S-2013-324

TRUMPET INTERCHANGE

STANDARD SIGNING PLAN

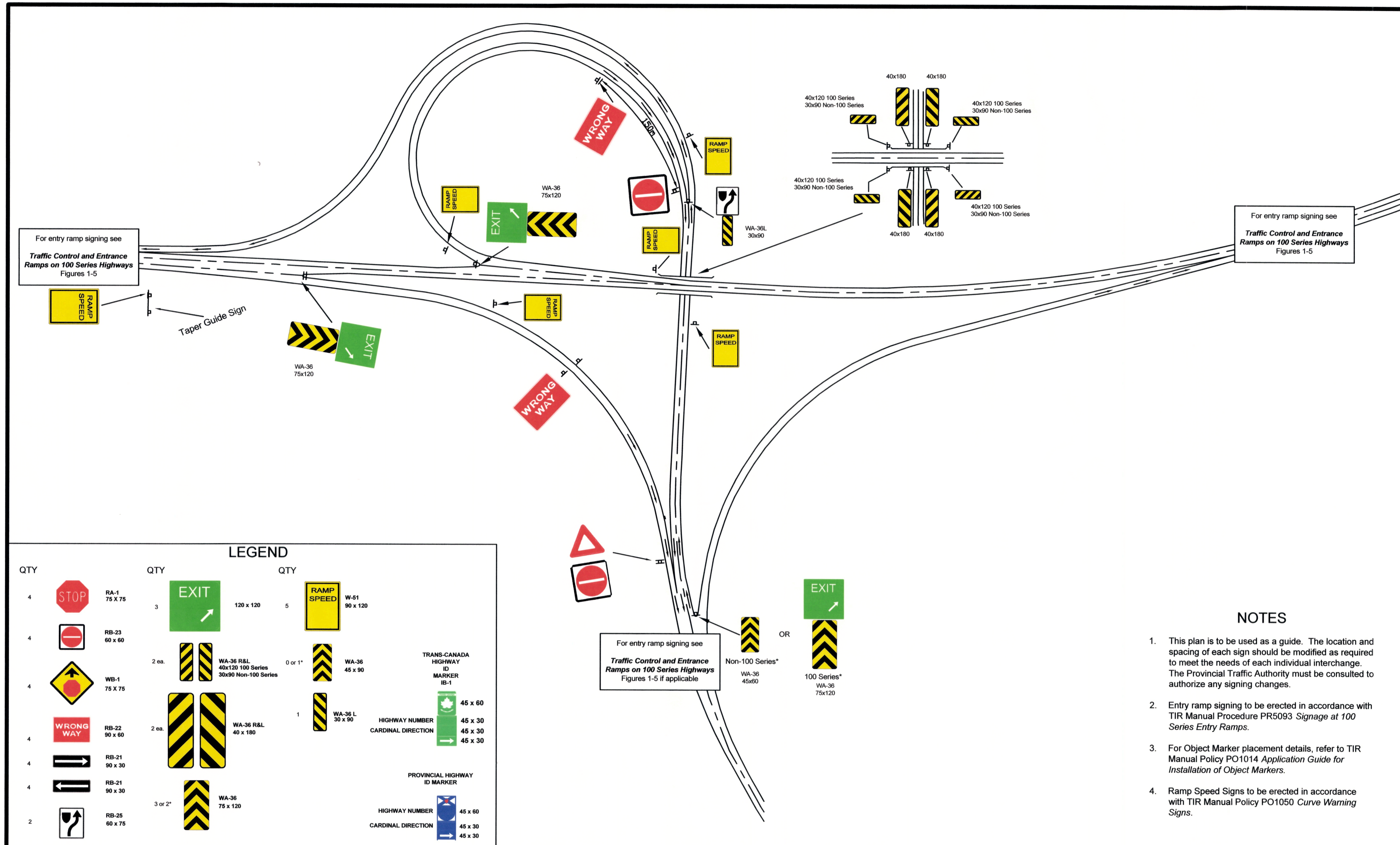

For entry ramp signing see
Traffic Control and Entrance Ramps on 100 Series Highways
Figures 1-5

For entry ramp signing see
Traffic Control and Entrance Ramps on 100 Series Highways
Figures 1-5

For entry ramp signing see
Traffic Control and Entrance Ramps on 100 Series Highways
Figures 1-5 if applicable

LEGEND	
QTY	QTY
4	3
RA-1 75 x 75	120 x 120
4	5
RB-23 60 x 60	90 x 120
4	2 ea.
WB-1 75 x 75	40x120 100 Series 30x90 Non-100 Series
4	0 or 1*
RB-22 90 x 60	30 x 90
4	1
RB-21 90 x 30	45 x 60
4	2 ea.
RB-21 90 x 30	45 x 30
4	3 or 2*
RB-25 60 x 75	45 x 30
2	
	45 x 30

NOTES

1. This plan is to be used as a guide. The location and spacing of each sign should be modified as required to meet the needs of each individual interchange. The Provincial Traffic Authority must be consulted to authorize any signing changes.
2. Entry ramp signing to be erected in accordance with TIR Manual Procedure PR5093 *Signage at 100 Series Entry Ramps*.
3. For Object Marker placement details, refer to TIR Manual Policy PO1014 *Application Guide for Installation of Object Markers*.
4. Ramp Speed Signs to be erected in accordance with TIR Manual Policy PO1050 *Curve Warning Signs*.

Designed by:
Surveyed by:
Drawn by: BS, PH, DM
Checked by:
Approved by:

Manager Traffic Engineering Services
July 21, 2013
Date

Traffic Authority
July 31, 2013
Date

MK.	DATE	REVISION
1	July 2013	Notes 3 and 4 added, note 2 amended, sign quantities adjusted, surround updated

NOVA SCOTIA
Transportation and
Infrastructure Renewal

Scale: NTS
Date: October 2006
File No.: S-2013-324
Sheet No.: 1 of 1

STANDARD SIGNAGE
PLAN

TRUMPET
INTERCHANGE